

PERMIT MUST BE
POSTED AT THE
CONSTRUCTION SITE

Becker County Plan
835 Lake Ave, P O
Detroit Lakes, MN 56502-0707
Phone (218)-846-7314; Fax (218)-846-7266



170231000

Onsite Septic System Site Evaluation/Design Tax Parcel Number 170231000 911 Address 19533

Legal Description: DEROXP Club Section 21 TWP 138 Range 42

Lake Name MAUD Lake Classification ☒ RD ☐ GD ☐ NE Township Name LAKELAND

Owner's Name MARIE & JOHN LOKKEN Mailing Address 19533 DEROXP Rd

City Audubon, MN State/Zip 56511 Phone Number 439-6323

Number of Bedrooms 6050 Well Casing Depth 750 Garbage Disposal (Yes) ☐ (No) ☒

Design Flow 2400 GPD Depth of other Wells within 100 ft of system NONE Grinder Pump/Lift Station In House (Yes) ☐ (No) ☒

Type of Observation: Probe ☐ Boring ☒ Original Soil (Yes) ☐ (No) ☒ Compacted Soil (Yes) ☐ (No) ☒ Proposed Design

Depth to Restricting Layer 76' ☐ Replace Septic Tank ☒ Chamber H10 EQ36 other ☐

Maximum Depth of System 2' ☒ Septic Tank/Drainfield ☐ Standard rock- depth ☐

Perc Rate 11 Soil Sizing Factor 1.27 ☐ Drainfield Only ☐ Standard gravelless ☐

☐ Holding Tank ☐ Mound ☐ Standard Bed ☐ Lift Station ☐ Pressurized Bed ☐ At Grade

SOIL BORING LOG

SOIL BORING LOG

DEPTH (INCHES)	TEXTURE	COLOR & MUNSELL NO.	STRUCTURE	DEPTH (INCHES)	TEXTURE	COLOR & MUNSELL NO.	STRUCTURE
0-5	SANDY LOAM	10YR2/1 BLACK	BLOCKY PLATY PRISMATIC <input checked="" type="checkbox"/> NONE	0-8	SANDY LOAM	10YR2/1 BLACK	BLOCKY PLATY PRISMATIC <input checked="" type="checkbox"/> NONE
5-11	SAND & LOAM	10YR4/3 BRN	BLOCKY PLATY PRISMATIC <input checked="" type="checkbox"/> NONE	8-14	SAND & LOAM	10YR4/3 BRN	BLOCKY PLATY PRISMATIC <input checked="" type="checkbox"/> NONE
11-17	LOAM	10YR5/3 BRN	BLOCKY PLATY PRISMATIC <input checked="" type="checkbox"/> NONE	14-20	GRAVEL & LOAM	10YR5/3 BRN	BLOCKY PLATY PRISMATIC <input checked="" type="checkbox"/> NONE
17-66	SAND & LOAM	10YR6/4 L.Y. BRN	BLOCKY PLATY PRISMATIC <input checked="" type="checkbox"/> NONE	20-66	SAND & LOAM	10YR6/4 L.Y. BRN	BLOCKY PLATY PRISMATIC <input checked="" type="checkbox"/> NONE

Type of alarm Device on lift Station or Holding tank

Attach perc test Information if Required

I hereby certify that I have completed this work in accordance with applicable ordinances, rules and laws.

Name and Address of Designer GRANT CHAM, Audubon, MN Phone 439-6428

MPCA Number 932 Date of Site Evaluation 8-20-02 Signature of Designer Grant Cham

Name of Installer (if different from Designer) _____ MPCA Number _____

FOR USE BY BECKER COUNTY ENVIRONMENTAL SERVICES DEPARTMENT ONLY

*** Any changes to the permit must first be approved by Becker County Planning & Zoning. No system shall be covered up without inspection by Becker County Planning & Zoning.

*** Inspections must be scheduled at least 24 hours prior to time requested.

Date Received	<u>8-27-02</u>	Application Fee	<u>250⁰⁰</u>	Fine	<u>0</u>	Total	<u>250⁰⁰</u>
[] Application is hereby denied							
[x] Application is hereby granted to <u>JOHN LOKKEN</u> to install an individual septic system according to the specifications of the site evaluation and design submitted to the Becker County Environmental Services Office. By Order of: <u>Nancy Young</u>							
Signature of Becker County Qualified Employee <u>Nancy Young</u>				Date Permit Issued <u>8-29-02</u>		Permit Number <u>18169c</u>	
This permit expires on <u>8-29-03</u>							

The site plan must be drawn to dimension or to scale:

*Dimensions of Lot

*Existing & Proposed Buildings

*Easements & setbacks

*Scale - One inch = _____ ft

*Well & Water Line Locations
within 100 ft of System

*Distance from Property Lines
*Distance from OHWM

*Tank Access Route
*Distance from buildings

*Location of any Unsuitable Soil

*Soil Borings & Per Test Locations

*Alternate Drainfield Location

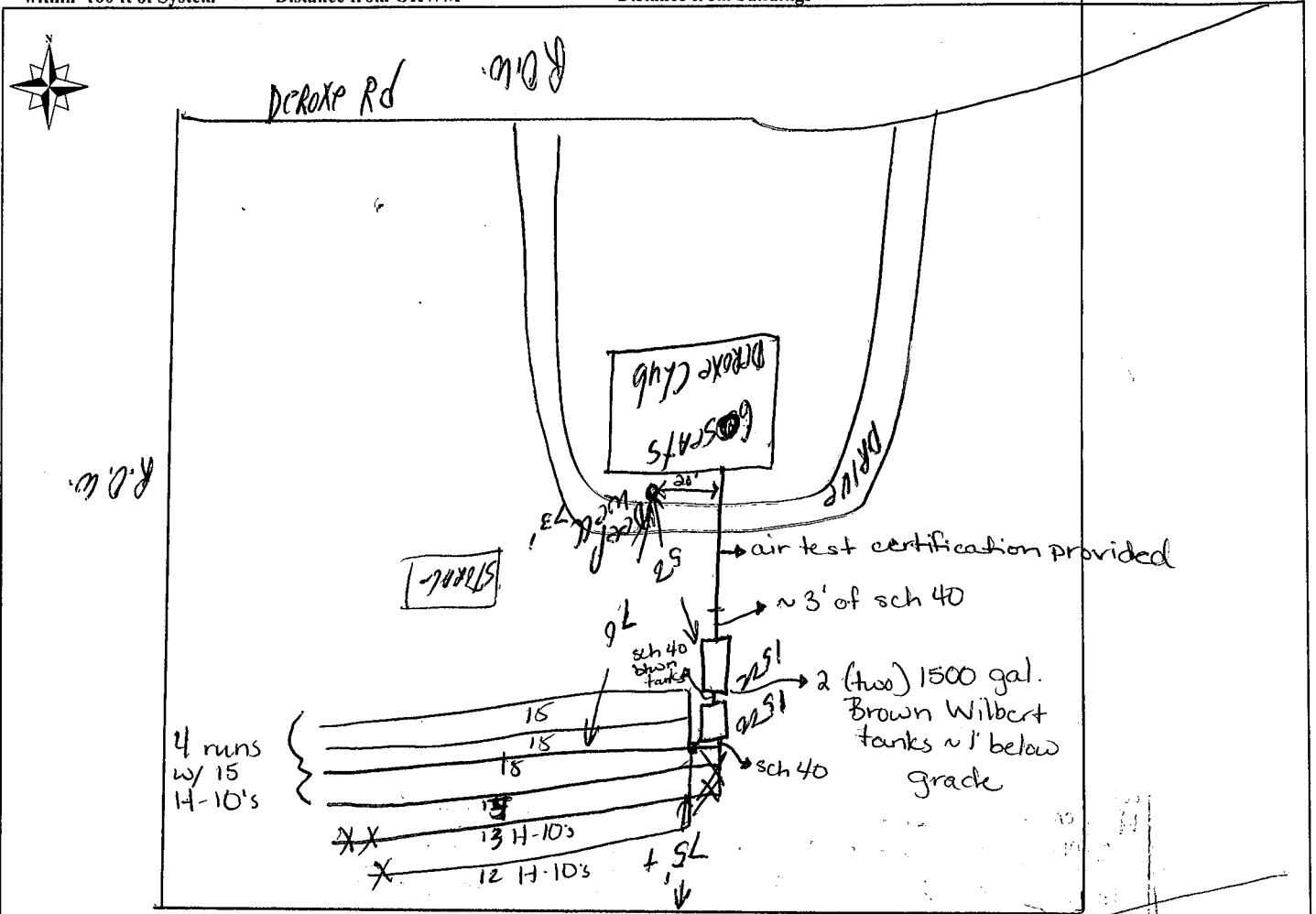

	Tank (estimated)	Tank* (actual)*	Drainfield (estimated)	Drainfield* (actual)*
Distances to Well	50	50'	75	+50'
Distance to Building	50	+18'	70	+20'
Distance to Property Line	710	+10'	118	+10'
Distance to Pressure Line	-	+10'	-	+10'
Distance to Ordinary High Water	100+	+75	100+	+75'

*For office use only
 Tank size 2-1500
 Lift station size 12"
 Drainfield size 2640 sq
 Pump HP 1/2
 Date Installed 9-2-02

FOR USE BY BECKER COUNTY ENVIRONMENTAL SERVICES DEPARTMENT ONLY

CERTIFICATE OF COMPLIANCE

() Certificate Is Hereby Denied

(✓) Certificate is Hereby Granted Based upon the Application, addendum from, plans, specifications and all other supporting data.
 With property maintenance, this system can be expected to function satisfactory, however, this is not a guarantee.

Nancy Young
 Signature

Zoning Inspector
 Title

9.4.02
 Date

(Certificate of Compliance is not valid unless signed by a Registered Qualified Employee)

AIR TEST CERTIFICATION

On 9-3-02 (Date), an air test of the sewer line installed under Sewage
Disposal System Permit Number 18169C for DeRose Club
Owner), on LAKE MANE (Lake/River) was made. At that time, the sewer
line held 5 pounds per square inch for 15 minutes.

[Signature]

Installer's Signature

932

License Number

Date

042991